

ACCESSORIES (Optional)

CRADLE CRDL 09/40/50

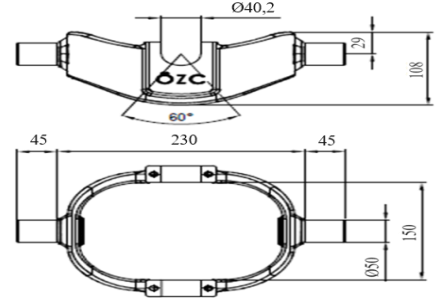

CHASSIS BRACKET SBR 04/50

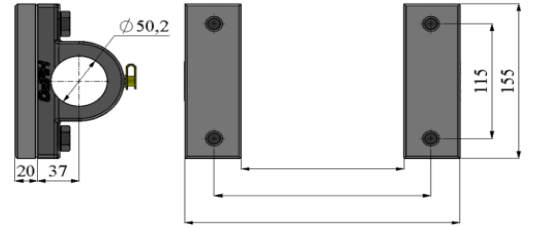

PULL OUT

When mounting the cylinder, the inner stage is mounted by opening +15/+20 mm.

UNITS TABLE (mm)

A :	138	I :	100
B :	108	J :	SØ59
C :	40	K :	150
D :	148	L :	545
E :	40	M :	N/A
F :	N/A	N :	N/A
G :	N/A	R :	N/A
H :	N/A	T :	G 1/2"

TECH. SPECIFICATIONS

Max. Pressure :	190 bar
Cylinder Weight (Kg) :	80
Total Oil Volume (Lt) :	13
Closed Length (mm) :	150
Opened Length (mm) :	1650
Total Stroke (mm) :	1500
Oil Inlet :	G 1/2"

Stages	1	2	3	4	5	6	7	8	9	10	TOTAL
Stage Diameter (Ø)	115	95	75	55	40						
Stroke (mm)	300	300	300	300	300						1500
Max. Thrust (Ton)	19,7	13,5	8,4	4,5	2,4						



USING INSTRUCTION

This cylinder is used only as a lifting device. This cylinder is designed for longitudinal loads. It should not be used in a horizontal position.

The cylinder should not be used as any supporting structural device. The operating temperature range of the hydraulic oil should be selected between -40°C and +80°C.



CYLINDER INFORMATION

The cylinders are produced in standard RAL 9005 coded black paint and the minimum thickness has been subjected to ISO 9227 natural salt spray test for 480 hours. All stages are 20 µm hard chromed. The trunnions are made of cast steel or forged steel. Cylinder heads are made of forged steel. All stages are manufactured from seamless cold drawn S35530 quality material.



SAFETY RULES

Do not operate above the permissible working pressure and load capacity. Adjust the safety valve only to the permissible working pressure. Pay attention to the characteristics of the hydraulic oil used in the cylinder and use a filter. Do not load over capacity and unbalanced load on the vehicle.

NOTES

REVISIONS

Please contact our Technical Dep. For your other questions

Technical Calculations

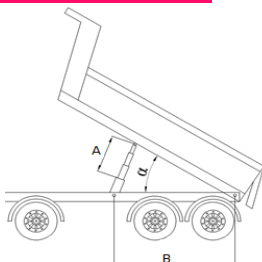

$$\alpha^\circ = \frac{Ax60}{B} \quad F (N) = 10 \times C (cm^2) \times P (bar)$$

α° :	Body Angle (°)	F :	Thrust (Newton)
A :	Stroke (mm)	C :	Area (cm ²)
B :	Pivot Length (mm)	P :	Pressure (bar)

$$10 N \approx 1 Kg$$

BODY ANGLE (α°)

α°	40	45	50	55	60
STROKE (A)	1500				
PIVOT L. (B)	2250	2000	1800	1636	1500

HMS ÖZCEYLANLAR HİDROLİK MAKİNE SAN. TİC. A.Ş.

Organized Industrial Zone Evrenköy Street No:25 Pk:42050 KONYA/TURKEY

www.ozceylanlar.com